

Flat gaskets

for cable entry frames

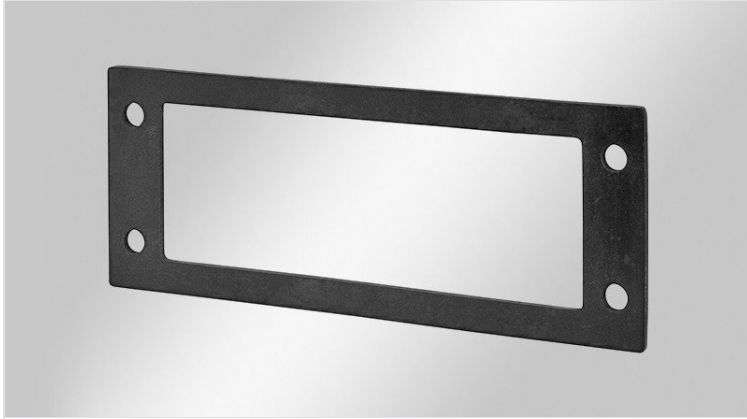

A flat gasket is provided to ensure a clean seal between the cable entry frame and the enclosure / control panel wall. Although this gasket is included in delivery, it can also be ordered separately. The standard gaskets for our KEL cable entry frames are self-adhesive on one side. This facilitates the alignment and assembly of the gasket.

Advantages & benefits

- Clean seal between the cable entry frame and the enclosure / control panel wall
- Self-adhesive for easier alignment and assembly

Product types & sizes

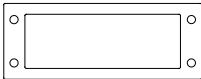
Gasket 24	Part No.	42246	Cut-out size	112 × 36 mm
	EAN	4251269332647	No. of screw holes	4
	Package quantity	10	Diam. of screw holes	6 mm
	Length	145 mm	Colour	black
	Width	56 mm	Suitable for cable entry systems:	KEL 24, KEL-U 24, KEL-ER 24, KEL-QUICK 24, KEL-FG-A, KEL-FG-ER A
	Height	2,5 mm		
	Mounting height	2,5 mm		

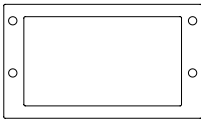
Gasket 24-E	Part No.	42254	Cut-out size	112 × 66 mm
	EAN	4251269332678	No. of screw holes	4
	Package quantity	1	Diam. of screw holes	6 mm
	Length	143 mm	Colour	black
	Width	83 mm	Suitable for cable entry systems:	KEL 24-E
	Height	3 mm		
	Mounting height	3 mm		

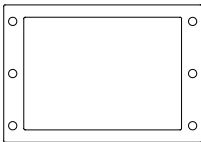
Gasket 24-MT	Part No.	42253	Cut-out size	112 × 82 mm
	EAN	4251269332661	No. of screw holes	6
	Package quantity	1	Diam. of screw holes	6 mm
	Length	143 mm	Colour	black
	Width	100 mm	Suitable for cable entry systems:	KEL 24-MT
	Height	3 mm		
	Mounting height	3 mm		

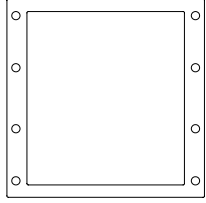
Gasket 24-2MT

Part No. **42255**
 EAN **4251269332685**
 Package quantity **1**
 Length **143 mm**
 Width **144,5 mm**
 Height **3 mm**
 Mounting height **3 mm**

Cut-out size **112 × 126 mm**
 No. of screw holes **8**
 Diam. of screw holes **6 mm**
 Colour **black**
 Suitable for cable entry systems: **KEL 24-2MT**

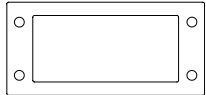
Gasket 16

Part No. **42170**
 EAN **4251269332616**
 Package quantity **10**
 Length **118 mm**
 Width **56 mm**
 Height **3 mm**
 Mounting height **3 mm**

Cut-out size **86 × 36 mm**
 No. of screw holes **4**
 Diam. of screw holes **6 mm**
 Colour **black**
 Suitable for cable entry systems: **KEL 16, KEL-U 16, KEL-ER 16, KEL-QUICK 16**

Gasket 16-E

Part No. **42142**
 EAN **4251269332586**
 Package quantity **1**
 Length **118 mm**
 Width **83 mm**
 Height **3 mm**
 Mounting height **3 mm**

Cut-out size **86 × 66 mm**
 No. of screw holes **4**
 Diam. of screw holes **6 mm**
 Colour **black**
 Suitable for cable entry systems: **KEL 16-E**

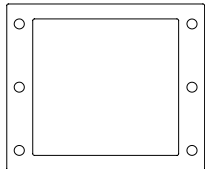
Gasket 16-MT

Part No. **42146**
 EAN **4251269332593**
 Package quantity **1**
 Length **118 mm**
 Width **100 mm**
 Height **3 mm**
 Mounting height **3 mm**

Cut-out size **86 × 82 mm**
 No. of screw holes **6**
 Diam. of screw holes **6 mm**
 Colour **black**
 Suitable for cable entry systems: **KEL 16-MT**

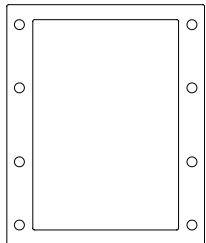
Gasket 16-2MT

Part No. **42150**
 EAN **4251269332609**
 Package quantity **1**
 Length **118 mm**
 Width **144,5 mm**
 Height **3 mm**
 Mounting height **3 mm**

Cut-out size **86 × 126 mm**
 No. of screw holes **8**
 Diam. of screw holes **6 mm**
 Colour **black**
 Suitable for cable entry systems: **KEL 16-2MT**

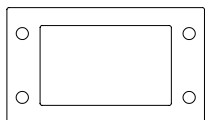
Gasket 10

Part No. **42257**
 EAN **4251269332708**
 Package quantity **10**
 Length **98,3 mm**
 Width **58 mm**
 Height **2,5 mm**
 Mounting height **2,5 mm**

Cut-out size **65 × 36 mm**
 No. of screw holes **4**
 Diam. of screw holes **6 mm**
 Colour **black**
 Suitable for cable entry systems: **KEL 10, KEL-U 10, KEL-ER 10, KEL-QUICK 10**

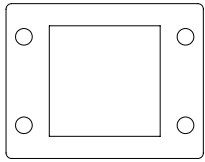
Gasket B

Part No. **42452**
 EAN **4251269332746**
 Package quantity **10**
 Length **70,8 mm**
 Width **56 mm**
 Height **2,5 mm**
 Mounting height **2,5 mm**

Cut-out size **46 × 46 mm**
 No. of screw holes **4**
 Diam. of screw holes **6 mm**
 Colour **black**
 Suitable for cable entry systems: **KEL-B, KEL-U-B, KEL-ER-B**

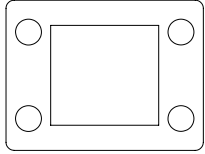
Gasket QUICK-B

Part No. **42451**
 EAN
 Package quantity **10**
 Length **72,85 mm**
 Width **55,6 mm**
 Height **2,5 mm**
 Mounting height **2,5 mm**

Cut-out size **46 × 46 mm**
 No. of screw holes **4**
 Diam. of screw holes **9,5 mm**
 Colour **black**
 Suitable for cable entry systems: **KEL-QUICK-B**

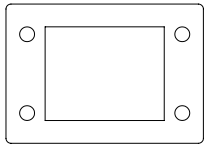
Gasket FG-B

Part No. **42331**
 EAN **4251269332715**
 Package quantity **1**
 Length **72,85 mm**
 Width **55,6 mm**
 Height **2,5 mm**
 Mounting height **2,5 mm**

Cut-out size **46 × 46 mm**
 No. of screw holes **4**
 Diam. of screw holes **9,5 mm**
 Colour **black**
 Suitable for cable entry systems: **KEL-FG-B, KEL-FG-ER B**

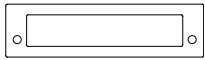
Gasket E5

Part No. **42251**
 EAN **4251269332654**
 Package quantity **10**
 Length **147 mm**
 Width **40 mm**
 Height **2,5 mm**
 Mounting height **2,5 mm**

Cut-out size **112 × 24 mm**
 No. of screw holes **2**
 Diam. of screw holes **6 mm**
 Colour **black**
 Suitable for cable entry systems: **KEL-E5, KEL-ER-E5, KEL-QUICK-E5, KEL-FG-E5, KEL-FG-ER E5, KEL-FL 4**

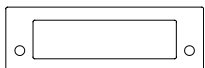
Gasket E4

Part No. **42198**
 EAN **4251269332630**
 Package quantity **10**
 Length **120 mm**
 Width **40 mm**
 Height **2,5 mm**
 Mounting height **2,5 mm**

Cut-out size **86 × 24 mm**
 No. of screw holes **2**
 Diam. of screw holes **6 mm**
 Colour **black**
 Suitable for cable entry systems: **KEL-E4, KEL-ER-E4, KEL-QUICK-E4, KEL-FL 3**

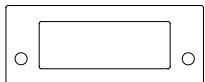
Gasket E3

Part No. **42197**
 EAN **4251269332623**
 Package quantity **10**
 Length **98 mm**
 Width **40 mm**
 Height **2,5 mm**
 Mounting height **2,5 mm**

Cut-out size **65 × 24 mm**
 No. of screw holes **2**
 Diam. of screw holes **6 mm**
 Colour **black**
 Suitable for cable entry systems: **KEL-E3, KEL-ER-E3, KEL-QUICK-E3, KEL-FG-E3, KEL-FG-ER E3, KEL-FL 2**

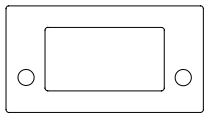
Gasket E2

Part No.	42256	Cut-out size	43 × 24 mm
EAN	4251269332692	No. of screw holes	2
Package quantity	10	Diam. of screw holes	6 mm
Length	72,8 mm	Colour	black
Width	40 mm	Suitable for cable entry systems:	KEL-E2, KEL-ER-E2, KEL-QUICK-E2, KEL-FG-E2, KEL-FG-ER E2, KEL-FL 1
Height	2,5 mm		
Mounting height	2,5 mm		

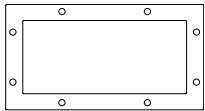
Gasket 183

Part No.	47110	No. of screw holes	8
EAN	4251269332753	Diam. of screw holes	7 mm
Package quantity	1	Colour	black
Length	220 mm	Suitable for cable entry systems:	KEL 183
Width	118 mm		
Height	2,5 mm		
Mounting height	2,5 mm		

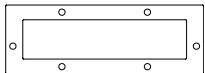
Gasket 183-E

Part No.	47111	No. of screw holes	6
EAN	4251269332760	Diam. of screw holes	7 mm
Package quantity	1	Colour	black
Length	220 mm	Suitable for cable entry systems:	KEL 183-E
Width	77 mm		
Height	2,5 mm		
Mounting height	2,5 mm		

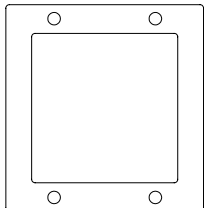
Gasket JUMBO 1

Part No.	42361	No. of screw holes	4
EAN	4251269332739	Diam. of screw holes	7 mm
Package quantity	1	Colour	black
Length	110,3 mm	Suitable for cable entry systems:	KEL-JUMBO 1
Width	116,3 mm		
Height	2 mm		
Mounting height	2 mm		

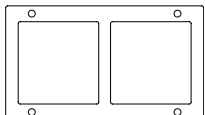
Gasket JUMBO 2

Part No.	42351	No. of screw holes	4
EAN	4251269332722	Diam. of screw holes	7 mm
Package quantity	1	Colour	black
Length	200,3 mm	Suitable for cable entry systems:	KEL-JUMBO 2
Width	116,3 mm		
Height	2 mm		
Mounting height	2 mm		